

**ARC STUDS
STANDARD THREAD**

ARC ST

STUD						
D	MIN L	BD	MIN BL	FD	FH	FERRULE CODE
1/4	3/4	.215	.375	.312	.093	P250
5/16	3/4	.275	.375	.406	.109	P312
3/8	3/4	.330	.390	.468	.109	P375
7/16	3/4	.387	.437	.531	.125	P437
1/2	7/8	.446	.500	.593	.156	P500
5/8	1	.562	.625	.750	.187	P625
3/4	1-1/4	.680	.796	.920	.250	P750
7/8	1-3/8	.798	.859	1.046	.312	P875
1"	1-1/2	.913	.921	1.187	.375	P1,000

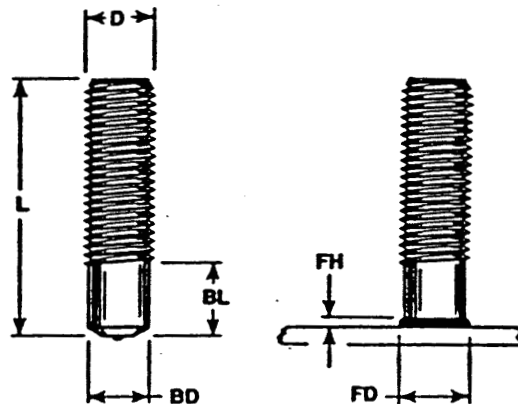

THREADS: Standard thread is UNC-2A (Rolled when possible), other threads are available upon request. Maximum standard thread length is 3-7/8"

MATERIAL	LOW CARBON STEEL		STAINLESS STEEL
		C - 0.23% max. Mn - 0.90% max.	P - 0.04% max. S - 0.05% max.
MECHANICAL PROPERTIES	Tensile 60,000 psi (min.) Yield 50,000 psi (min.) Elongation 20% (in 2 inches)		Values for various grades available upon request.
PLATING	Plating is not standard. Copper, Nickel, and Zinc available upon customer request.		Does not apply to Stainless.

FERRULES: Ferrules are component parts of studs. Not sold separately.

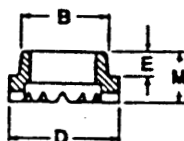

TO ORDER OR SPECIFY GIVE:

1. Product Code ARC ST
2. Diameter D
3. Length L
4. Material

ARC STUDS
FULL THREAD

ARC FT

STUD				
D	MIN † L	FD	FH	FERRULE CODE
#10	3/4"	.281	.093	F187
1/4	3/4"	.359	.109	F250
5/16	3/4"	.437	.109	F312
3/8	3/4"	.500	.125	F375
7/16	7/8	.578	.140	F437
1/2	7/8	.625	.156	F500
5/8	1-1/8	.796	.187	F625
3/4	1-1/8	.937	.250	F750
7/8	1-1/2	1.093	.312	F875

THREADS: Standard thread is UNC-2A (Rolled when possible), other threads are available upon request. Maximum standard thread length is 3-7/8"

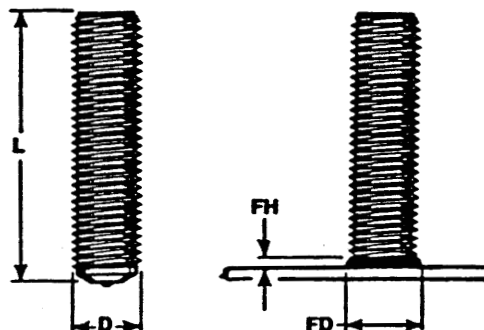

† KNOCK-OFF studs are available if shorter lengths are required.

MATERIAL	LOW CARBON STEEL C - 0.23% max. P - 0.04% max. Mn - 0.90% max. S - 0.05% max.	STAINLESS STEEL AISI grade - 302/304/305 std. Other grades available upon request.
MECHANICAL PROPERTIES	Tensile 60,000 psi (min.) Yield 50,000 psi (min.) Elongation 20% (in 2 inches)	Values for various grades available upon request.
PLATING	Plating is not standard. Copper, Nickel, and Zinc available upon customer request.	Does not apply to Stainless.

FERRULES: Ferrules are component parts of studs. Not sold separately.

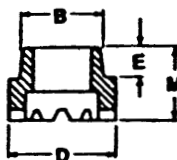

TO ORDER OR SPECIFY GIVE:

1. Product Code **ARC FT**
2. Diameter **D**
3. Length **L**
4. Material

**ARC STUDS
NO THREAD**

ARC NT

STUD				
D	MIN † L	FD	FH	FERRULE CODE
3/16	3/4"	.281	.093	F187
1/4	3/4"	.359	.109	F250
5/16	3/4"	.437	.109	F312
3/8	3/4"	.500	.125	F375
7/16	3/4"	.578	.140	F437
1/2	7/8	.627	.156	F500
5/8	1"	.796	.187	F625
3/4	1-1/8	.937	.250	F750
7/8	1-1/4	1.093	.312	F875
1"	1-1/2	1.312	.375	F1,000

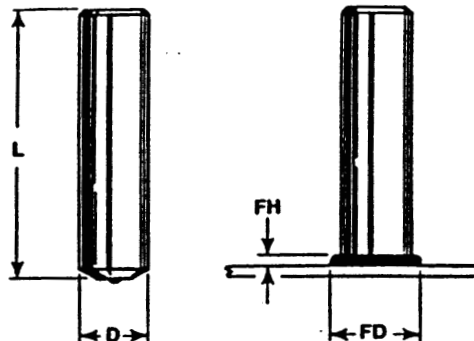

† KNOCK-OFF studs are available if shorter lengths are required.

* Curved ferrules are available upon request.

MATERIAL	LOW CARBON STEEL C - 0.23% max. P - 0.04% max. Mn - 0.90% max. S - 0.05% max.	STAINLESS STEEL AISI grade - 302/304/305 std. Other grades available upon request.
MECHANICAL PROPERTIES	Tensile 60,000 psi (min.) Yield 50,000 psi (min.) Elongation 20% (in 2 inches)	Values for various grades available upon request.
PLATING	Plating is not standard. Copper, Nickel, and Zinc available upon customer request.	Does not apply to Stainless.

FERRULES: Ferrules are component parts of studs.
Not sold separately.

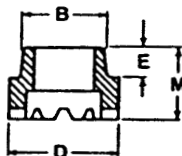

TO ORDER OR SPECIFY GIVE:

1. Product Code **ARC NT**
2. Diameter **D**
3. Length **L**
4. Material

ARC STUDS TAPPED-FULL BASE

ARC TAPFB

STUD						
D	MIN L	TD	TL*	MAX FD	MAX FH	FERRULE CODE
1/4	9/16	8-32	1/4	.359	.109	F250
5/16	21/32	10-24	9/32	.437	.109	F312
3/8	13/16	1/4-20	3/8	.500	.125	F375
7/16	29/32	5/16-18	15/32	.578	.140	F437
1/2	1-1/32	3/8-16	9/16	.625	.156	F500
5/8	1-9/32	7/16-14	21/32	.796	.187	F625
3/4	1-3/8	1/2-13	3/4	.937	.250	F750
7/8	1-5/8	5/8-11	15/16	1.093	.312	F875

* Maximum standard tap depth equals 1-1/2 times tap diameter.

TAPS: Standard tap is UNC-2B, other taps are available.

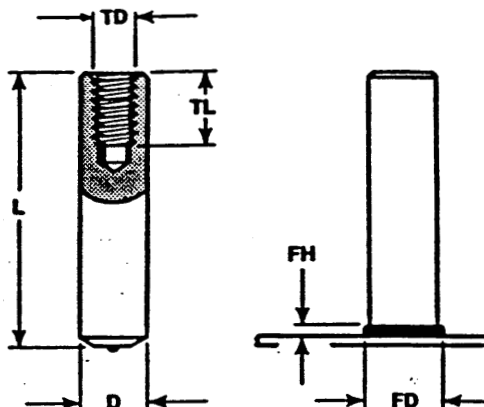

MATERIAL	LOW CARBON STEEL	STAINLESS STEEL
	C - 0.23% max. Mn - 0.90% max.	P - 0.04% max. S - 0.05% max. AISI grade - 302/304/305 std. Other grades available upon request.
MECHANICAL PROPERTIES	Tensile 60,000 psi (min.) Yield 50,000 psi (min.) Elongation 20% (in 2 inches)	Values for various grades available upon request.
PLATING	Plating is not standard. Copper, Nickel, and Zinc available upon customer request.	Does not apply to Stainless.

FERRULES: Ferrules are component parts of studs.
Not sold separately.

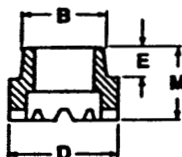

TO ORDER OR SPECIFY GIVE:

1. Product Code ARC TAPFB
2. Diameter D
3. Length L
4. Tap Diameter TD
5. Tap Length TL
6. Material

**ARC STUDS
TAPPED - REDUCED BASE**

ARC TAPRB

STUD						
D	MIN L	TD	TL*	BD	BL	FERRULE CODE
3/8	1-1/2	1/4-20	3/8	.250	7/16	FS250
1/2	1-1/2	3/8-16	9/16	.375	7/16	FS375
5/8	1-1/2	7/16-14	21/32	.500	1/2	FS500
3/4	1-1/2	1/2-13	3/4	.500	1/2	FS500
7/8	2	5/8-11	15/16	.625	5/8	FS625
1"	2-1/2	3/4-10	1"	.750	5/8	FS750

* Maximum standard tap depth equals 1-1/2 times tap diameter.

TAPS: Standard tap is UNC-2B, other taps are available.

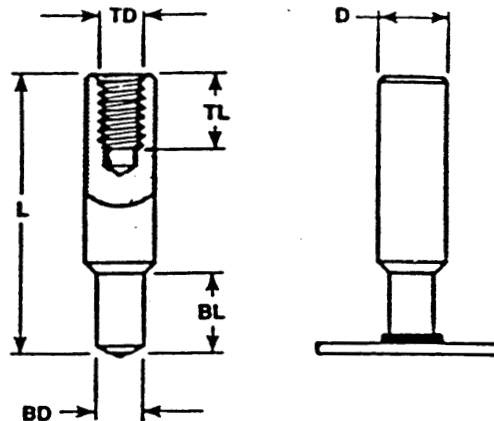

MATERIAL	LOW CARBON STEEL	STAINLESS STEEL
	C - 0.23% max. Mn - 0.90% max.	P - 0.04% max. S - 0.05% max.
MECHANICAL PROPERTIES	Tensile 75,000 psi (max.) Yield 64,000 psi (max.) Elongation 20% (in 2 inches)	Values for various grades available upon request.
PLATING	Plating is not standard. Copper, Nickel, and Zinc available upon customer request.	Does not apply to Stainless.

FERRULES: Ferrules are component parts of studs. Not sold separately.

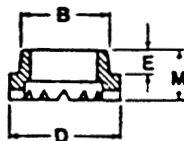

TO ORDER OR SPECIFY GIVE:

1. Product Code ARC TAPRB
2. Base Diameter BD
3. Base Length BL
4. Thread Diameter TD
5. Thread Length TL
6. Material

ARC STUDS DEFORMED BAR ANCHOR

ARC DBA

STUD		
D	MIN L	FERRULE CODE
3/8	10-1/8	F375
1/2	8-1/8	F500
5/8	12-3/16	F625
3/4	12-3/16	F750

MATERIAL	A-108 & A29
MECHANICAL PROPERTIES	AWS D1.1

SPECS: All DBA studs conform to the requirements of ASTM A 496.

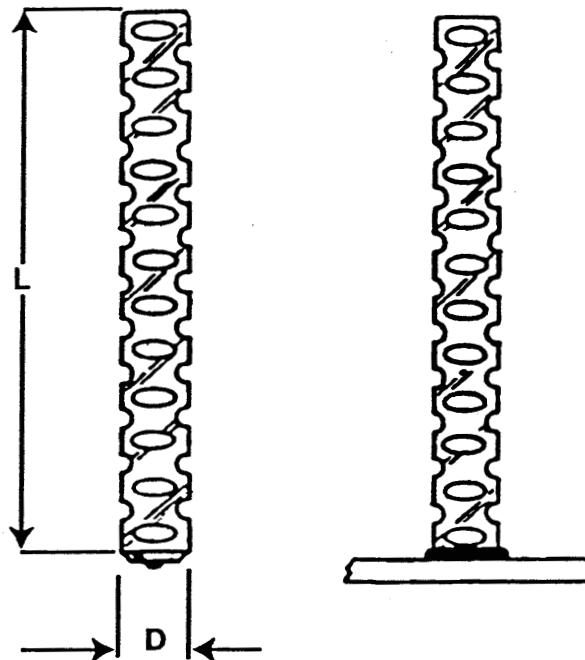

FERRULES: Ferrules are component parts of studs.
Not sold separately.

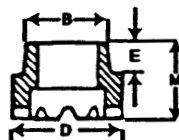

TO ORDER OR SPECIFY GIVE:

1. Product CodeARC DBA
2. Diameter **D**
3. Length **L**
4. Material

**ARC STUDS
HEADED CONCRETE ANCHOR**

ARC HCA

STUD				
D	MIN L	HD	HT	FERRULE CODE★
1/4	1-1/8	1/2	3/16	F250
3/8	1-1/4	3/4	9/32	F375
1/2	1-1/8	1"	5/16	F500
5/8	1-7/16	1-1/4	5/16	F625

MATERIAL	ASTM A-108 & A29
MECHANICAL PROPERTIES	AWS D1.1

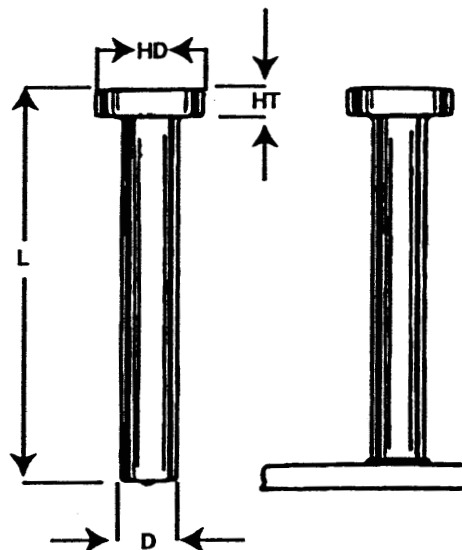

OTHER MATERIALS: Also available in stainless steel.
SPECS: All ARC HCA studs meet AWS specifications. Test reports available upon request.

★ **HEADED CONCRETE ANCHORS** are available for welding to flat surfaces, inside angles, outside angles. Each of these applications requires the proper style stud and ferrule, so please specify your application when ordering studs.

FERRULES: Ferrules are component parts of studs. Not sold separately. Ferrule exterior dimensions are available upon request.

FLAT SURFACE (F)

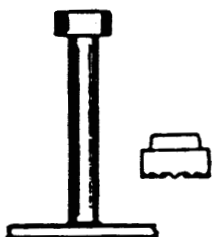

INSIDE ANGLE (IA)

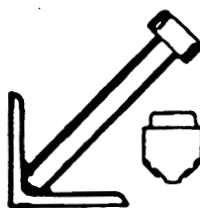

OUTSIDE ANGLE (OA)

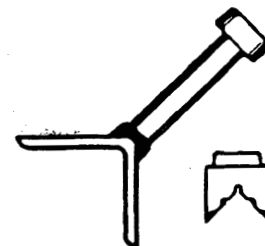

TO ORDER OR SPECIFY GIVE:

1. Product Code **ARC HCA**
2. Diameter **D**
3. Length **L**
4. Material
5. Welding Application

ARC STUDS SHEAR CONNECTOR

ARC SC

STUD				
D	MIN L	HD	HT	FERRULE CODE★
3/4	2-3/16	1-1/4	3/8	F750
7/8	2-3/16	1-3/8	3/8	F875
1	3-1/4	1-5/8	1/2	F1000

MATERIAL	A-108 & A29
MECHANICAL PROPERTIES	AWS D1.1

Other materials: Also available in Stainless Steel.
 SPECS: All ARC SC studs meet AWS, AASHTO, and ICC specifications. Test reports available upon request.

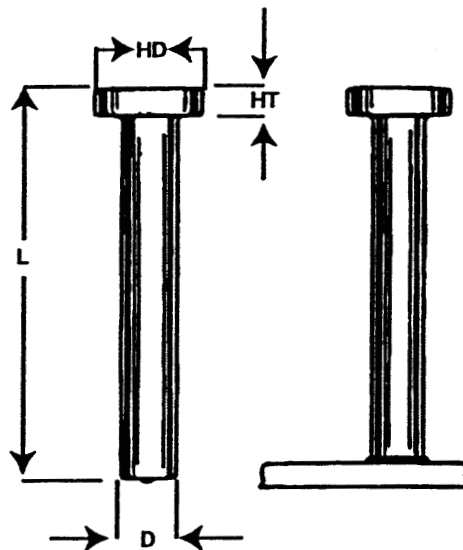

★ **SHEAR CONNECTORS** are available for welding to flat surfaces, inside angles, outside angles, and "thru deck". Each of these applications requires the proper style stud and ferrule, so please specify your application when ordering studs.

FERRULES: Ferrules are component parts of studs. Not sold separately. Ferrule exterior dimensions are available upon request.

FLAT SURFACE (F)

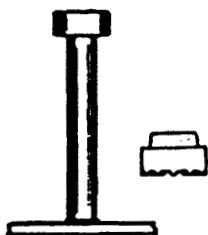

INSIDE ANGLE (IA)

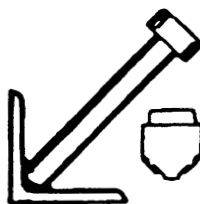

OUTSIDE ANGLE (OA)

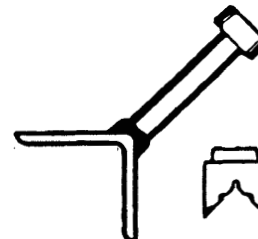

WELD THRU DECK (WTD)

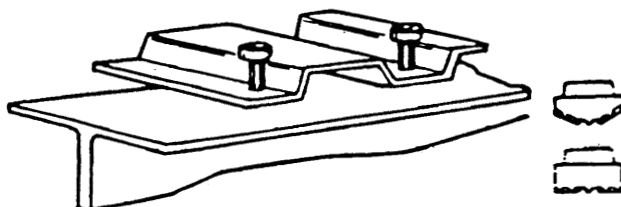

TO ORDER OR SPECIFY GIVE:

1. Product Code ARC SC
2. Diameter D
3. Length L
4. Material
5. Welding Application

ARC STUDS EYE BOLT

ARC EB

STUD					
D	MIN L	MIN BL	MIN ID	MIN G	FERRULE CODE
3/16	1-7/8	3/4	1/2	3/16	F187
1/4	1-3/4	3/4	3/4	1/4	F250
5/16	1-7/8	3/4	3/4	5/16	F312
3/8	2-5/8	1	7/8	3/8	F375
7/16	3	1-1/8	1	7/16	F437
1/2	3-5/8	1-3/8	1-1/4	1/2	F500

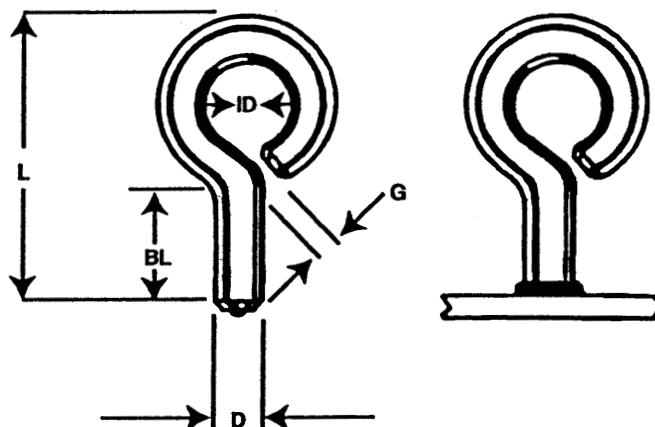

MATERIAL	LOW CARBON STEEL C - 0.23% max. P - 0.04% max. Mn - 0.90% max. S - 0.05% max.	STAINLESS STEEL AISI grade - 302/304/305 std. Other grades available upon request.
MECHANICAL PROPERTIES	Tensile 60,000 psi (min.) Yield 50,000 psi (min.) Elongation 20% (in 2 inches)	Values for various grades available upon request.
PLATING	Plating is not standard. Copper, Nickel, and Zinc available upon customer request	Does not apply to Stainless.

FERRULES: Ferrules are component parts of studs.
Not sold separately.

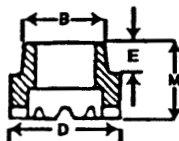

TO ORDER OR SPECIFY GIVE:

1. Product Code **ARC EB**
2. Diameter **D**
3. Length **L**
4. Eye Diameter **ID**
5. Gap **G**
6. Material

ARC STUDS
FULL BASE

ARC FB

STUD					
D	MIN L	MIN BL	MAX FD	MAX FH	FERRULE CODE
1/4	3/4"	.375	.335		F250
5/16	7/8	.375	.406	.125	F312
3/8		.500	.468	.141	F375
7/16	1-1/8	.500	.546	.156	F437
1/2	1-1/4	.500	.609	.172	F500
5/8	1-1/2	.500	.765	.266	F625
3/4	1-3/4	.675	.906	.335	F750
7/8	2-1/2	.750	1.046	.390	F875
1	2-1/2	1.000	1.203	.468	F1,000

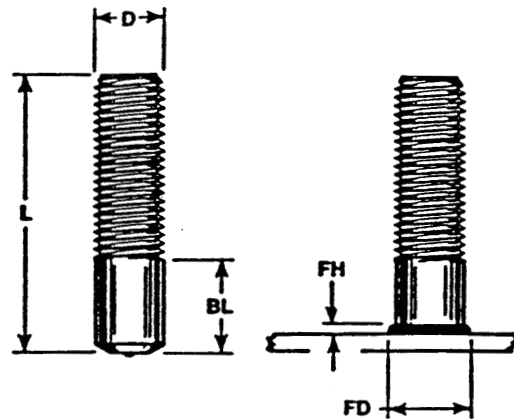

THREADS: Standard thread is UNC-2A (Rolled when possible), other threads are available upon request. Maximum standard thread length is 3-7/8."

MATERIAL	LOW CARBON STEEL	STAINLESS STEEL
	C - 0.23% max. Mn - 0.60% max.	P - 0.04% max. S - 0.05% max.
MECHANICAL PROPERTIES	Tensile 60,000 psi (max.) Yield 50,000 psi (max.) Elongation 20% (in 2 inches)	Values for various grades available upon request.
PLATING	Plating is not standard. Copper, Nickel, and Zinc available upon customer request.	Does not apply to Stainless.

FERRULES: Ferrules are component parts of studs. Not sold separately.

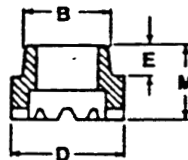

TO ORDER OR SPECIFY GIVE:

1. Product Code ARC FB
2. Diameter D
3. Length L
4. Material

**ARC STUDS
LONG REDUCED BASE**

ARC LRB

STUD						
D	MIN L	BD	MIN BL	FD	FH	FERRULE CODE
1/4	3/4	.187	.375	.281	.109	FS187
5/16	3/4	.250	.375	.359	.125	FS250
3/8	3/4	.312	.375	.437	.125	FS312
7/16	1	.375	.375	.500	.140	FS375
1/2	1	.437	.437	.578	.140	FS437
5/8	1-1/4	.500	.500	.656	.156	FS500
3/4	1-1/2	.625	.718			FS625

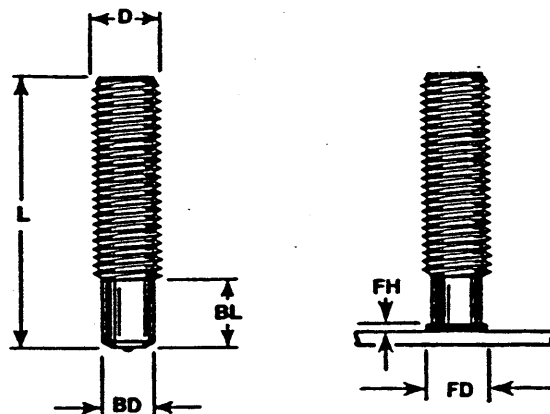

THREADS: Standard thread is UNC-2A (Rolled when possible), other threads are available. Maximum standard thread length is 3-7/8"

MATERIAL	LOW CARBON STEEL C - 0.23% max. P - 0.04% max. Mn - 0.90% max. S - 0.05% max.	STAINLESS STEEL AISI grade - 302/304/305 std. Other grades available upon request.
MECHANICAL PROPERTIES	Tensile 60,000 psi (min.) Yield 50,000 psi (min.) Elongation 20% (in 2 inches)	Values for various grades available upon request.
PLATING	Plating is not standard. Copper, Nickel, and Zinc available upon customer request.	Does not apply to Stainless.

FERRULES: Ferrules are component parts of studs.
Not sold separately.

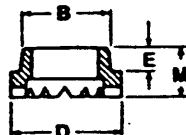

- TO ORDER OR SPECIFY GIVE:**
1. Product Code **ARC LRB**
 2. Diameter **D**
 3. Length **L**
 4. Material

ARC STUDS
SHORT REDUCED BASE

ARC SRB

STUD						
D	MIN L	BD	MIN BL	FD	FH	FERRULE CODE
1/4	7/8	.187	.156	.281	.109	TB250
5/16	7/8	.275	.250	.390	.109	RB312
3/8	7/8	.312	.250	.437	.125	RB375
1/2	1	.435	.250	.593	.156	RB500
5/8	1-1/8	.500	.312	.687	.156	TB625
3/4	1-1/8	.625	.375	.812	.187	TB750

THREADS: Standard thread is UNC-2A (Rolled when possible), other threads are available. Maximum standard thread length is 3-7/8"

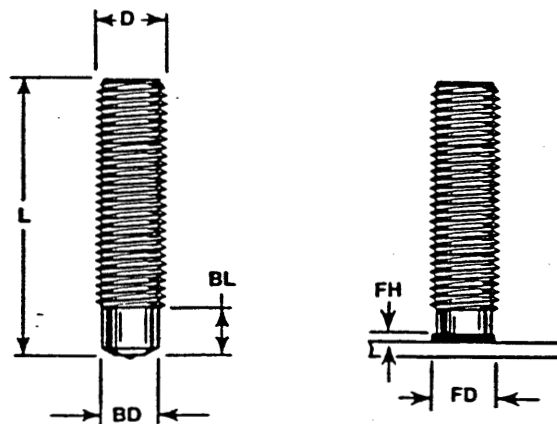

MATERIAL	LOW CARBON STEEL C - 0.23% max. P - 0.04% max. Mn - 0.90% max. S - 0.05% max.	STAINLESS STEEL AISI grade - 302/304/305 std. Other grades available upon request.
MECHANICAL PROPERTIES	Tensile 60,000 psi (min.) Yield 50,000 psi (min.) Elongation 20% (in 2 inches)	Values for various grades available upon request.
PLATING	Plating is not standard. Copper, Nickel, and Zinc available upon customer request.	Does not apply to Stainless.

FERRULES: Ferrules are component parts of studs. Not sold separately.

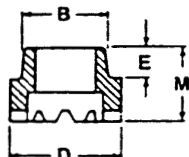

- TO ORDER OR SPECIFY GIVE:**
1. Product Code ARC SRB
 2. Diameter D
 3. Length L
 4. Material

FRB Welding Studs

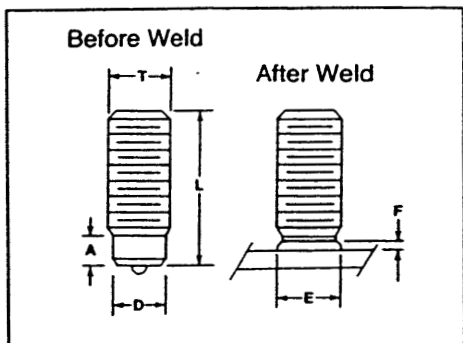

FRB (Full Reduced Base) welding studs are threaded fasteners with a weld base diameter $1/8''$ less than the major thread size (i.e. $3/8-16$ has $1/4''$ dia. weld base). The weld fillet will always be the same nominal diameter as the thread. Holes in mating parts can be normal clearance size for a given thread. Caution: FRB studs will not develop full thread strength. For sizes smaller than $5/16''$ or larger than $1/2''$, use RB studs.

Typical Use: In application where the mating part must fit closely over the stud with full nut run down.

Length Specifications: Standard lengths from $3/4''$ to $4''$ (BW).
Specifications: Material, Arc Shields and ordering data same as RB studs above.

Thread Size T	Weld Base Diameter (Nom.) D	Minimum Unthreaded Length (BW)	Minimum Length		Approximate Weld Bead Dimensions		Arc Shield Number
			Before Weld L(BW)	After Weld (Nom.) L(AW)	Dia. E	Hgt. F	
5/16-18	3/16	1/4	3/4	5/8	5/16	1/8	009-674
3/8 -18	1/4	1/4	3/4	5/8	3/8	1/8	009-675
7/16-14	5/16	9/32	3/4	5/8	7/16	5/32	009-676
1/2 -13	3/8	9/32	3/4	5/8	1/2	5/32	009-677

**ARC STUDS
BENT-COLLAR**

ARC B-COL

STUD						
TD	STD. TL	MIN BL	BD	CD	CT	X
3/8-16	1.375	.625	.331	5/8	.109	5/8

THREADS: Standard thread is UNC-2A (Rolled when possible), other threads are available upon request. Other diameters available upon request.

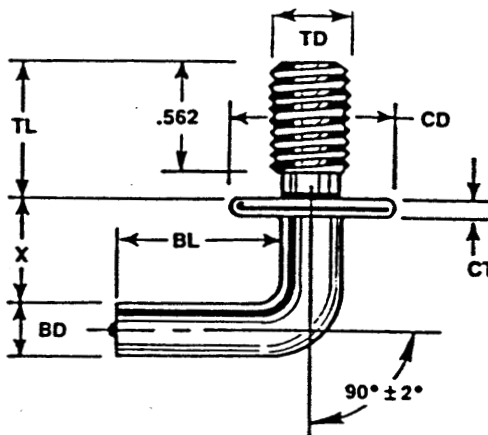

MATERIAL	LOW CARBON STEEL C - 0.23% max. P - 0.04% max. Mn - 0.60% max. S - 0.05% max.	STAINLESS STEEL AISI grade - 302/304/305 std. Other grades available upon request.
MECHANICAL PROPERTIES	Tensile 60,000 psi (min.) Yield 50,000 psi (min.) Elongation 20% (in 2 inches)	Values for various grades available upon request.
PLATING	Plating is not standard. Copper, Nickel, and Zinc available upon customer request.	Does not apply to Stainless.

FERRULES: Ferrules are component parts of studs. Not sold separately.

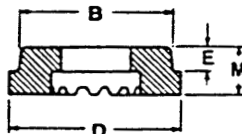

TO ORDER OR SPECIFY GIVE:

1. Product Code ARC B-COL
2. Base Diameter BD
3. Base Length BL
4. Thread Diameter TD
5. Thread Length TL
6. Material

ARC STUDS ANNULAR RING (NAVY)

ARC AR

STUD				
NOM D	MIN L	RD	RL	FERRULE CODE
3/16	3/4"	.175	.312	F187

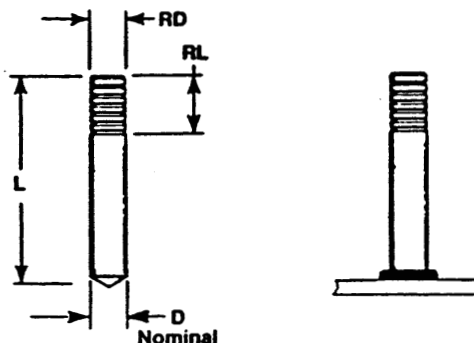

MATERIAL	LOW CARBON STEEL	STAINLESS STEEL
	C - 0.23% max. P - 0.04% max. Mn - 0.90% max. S - 0.05% max.	AISI grade - 302/304/305 std. Other grades available upon request.
MECHANICAL PROPERTIES	Tensile 60,000 psi (min.) Yield 50,000 psi (min.) Elongation 20% (in 2 inches)	Values for various grades available upon request.
PLATING	Plating is not standard. Copper, Nickel, and Zinc available upon customer request.	Does not apply to Stainless.

ALUMINUM Studs are available upon request (bulb end style).

WCN AR CAP

"Mushroom Cap"
(Aluminum)

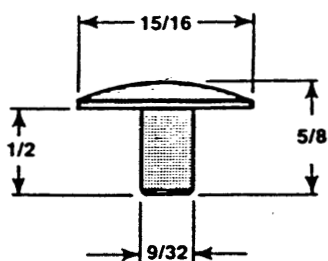

CAP: Sold separately. Not a component part of stud.

FERRULES: Ferrules are component parts of studs.
Not sold separately.

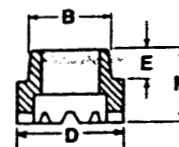

TO ORDER OR SPECIFY GIVE:

1. Product Code ARC AR
2. Diameter D
3. Length L
4. Material

**ARC STUDS
COLLAR**

ARC COL

STUD						
TD	MIN TL	BD	MIN BL	CD	CT	FERRULE CODE
1/4	.375	.215	.500	.500	.093	C250
5/16	.375	.275	.500	.562	.093	C312
3/8	.500	.330	.500	.625	.109	C375
1/2	.625	.448	.593	.750	.140	C500

THREADS: Standard thread is UNC-2A (Rolled when possible), other threads are available upon request.

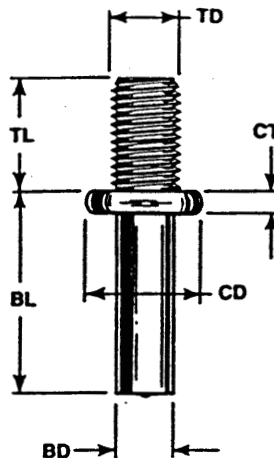

MATERIAL	LOW CARBON STEEL C - 0.23% max. P - 0.04% max. Mn-0.90% max. S - 0.05% max.	STAINLESS STEEL AISI grade - 302/304/305 std. Other grades available upon request.
MECHANICAL PROPERTIES	Tensile 60,000 psi (min.) Yield 50,000 psi (min.) Elongation 20% (in 2 inches)	Values for various grades available upon request.
PLATING	Plating is not standard. Copper, Nickel, and Zinc available upon customer request.	Does not apply to Stainless.

FERRULES: Ferrules are component parts of studs.
Not sold separately.

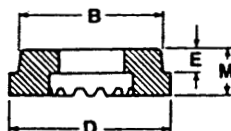

TO ORDER OR SPECIFY GIVE:

1. Product Code ARC COL
2. Base Diameter BD
3. Base Length BL
4. Thread Diameter TD
5. Thread Length TL
6. Material

**ARC STUDS
BENT-NO THREAD**

ARC B-NT

STUD				
D	MIN L	MIN X	MIN R	FERRULE CODE
1/4	1-1/8	1-1/4	.125	F250
5/16	1-1/4	1-1/2	.218	F312
3/8	1-1/2	1-1/2	.218	F375
7/16	1-5/8	1-5/8	.250	F437
1/2	1-3/4	1-3/4	.250	F500
5/8	1-7/8	2"	.312	F625
3/4	2-3/4	3"	.500	F750
7/8	3-1/2	3-3/8	.500	F875

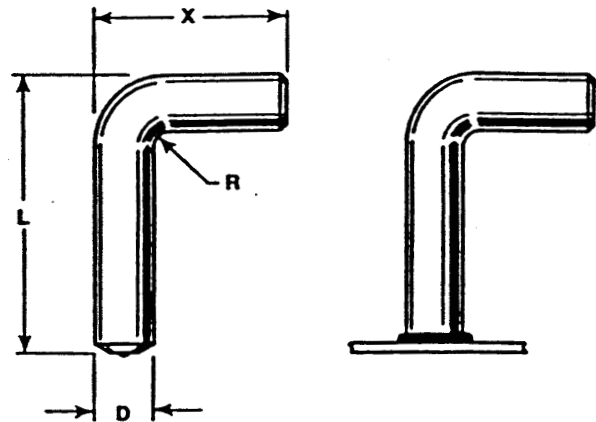

MATERIAL	LOW CARBON STEEL C - 0.23% max. P - 0.04% max. Mn - 0.90% max. S - 0.05% max.	STAINLESS STEEL AISI grade - 302/304/305 std. Other grades available upon request.
MECHANICAL PROPERTIES	Tensile 60,000 psi (min.) Yield 50,000 psi (min.) Elongation 20% (in 2 inches)	Values for various grades available upon request.
PLATING	Plating is not standard. Copper, Nickel, and Zinc available upon customer request.	Does not apply to Stainless.

FERRULES: Ferrules are component parts of studs.
Not sold separately.

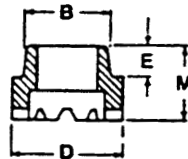

TO ORDER OR SPECIFY GIVE:

1. Product Code **ARC B-NT**
2. Diameter **D**
3. Length **L**
4. Length **X**
5. Material

ARC STUDS
SHOULDER - ANNULAR GROOVE

ARC SH-AG

STUD						
D	MIN L	GD	GL	FD	FH	FERRULE CODE
5/16	1"	.187	.375	.437	.109	F312
5/16	1"	.187	.437	.437	.109	F312

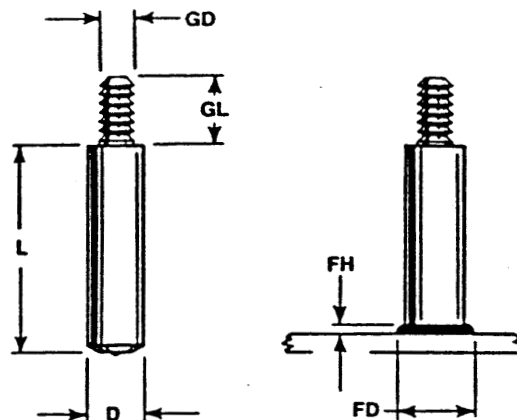

MATERIAL	LOW CARBON STEEL C - 0.23% max. P - 0.04% max. Mn - 0.90% max. S - 0.05% max.	STAINLESS STEEL AISI grade - 302/304/305 std. Other grades available upon request.
MECHANICAL PROPERTIES	Tensile 60,000 psi (min.) Yield 50,000 psi (min.) Elongation 20% (in 2 inches)	Values for various grades available upon request.
PLATING	Plating is not standard. Copper, Nickel, and Zinc available upon customer request.	Does not apply to Stainless.

WCN AG CAP

"Setting Cap"
(Aluminum)

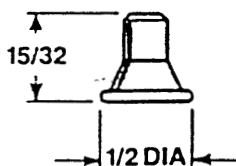

CAP: Sold separately. Not a component part of stud.
CAP-SETTING TOOL: for installing WCN AG CAP, available from stock.

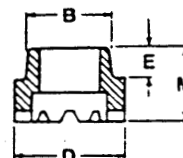

TO ORDER OR SPECIFY GIVE:

1. Product Code ARC SH-AG
2. Diameter D
3. Length L
4. Groove Diameter GD
5. Groove Length GL
6. Material

ARC STUDS

ARC SH-NT

SHOULDER - NO THREAD

STUD						
D	MIN L	ED	EL	FD	FH	FERRULE CODE
5/16	3/8	3/16	3/16	.437	.109	F312
3/8	3/8	3/16	3/16	.500	.125	F375
1/2	1/2	3/8	45/64	.627	.156	F500

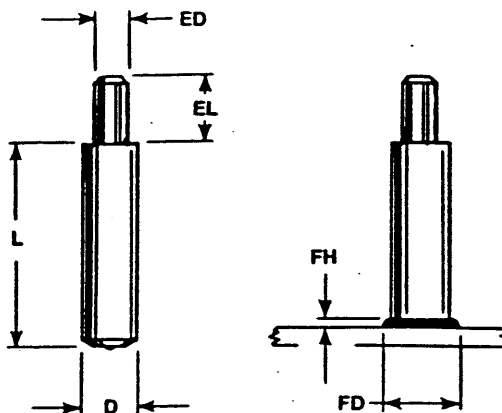

MATERIAL	LOW CARBON STEEL	STAINLESS STEEL
	C - 0.23% max. Mn - 0.90% max.	P - 0.04% max. S - 0.05% max.
MECHANICAL PROPERTIES	Tensile 60,000 psi (min.) Yield 50,000 psi (min.) Elongation 20% (in 2 inches)	Values for various grades available upon request.
PLATING	Plating is not standard. Copper, Nickel, and Zinc available upon customer request.	Does not apply to Stainless.

FERRULES: Ferrules are component parts of studs.
Not sold separately.

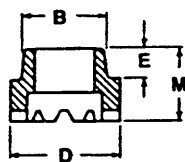

TO ORDER OR SPECIFY GIVE:

1. Product CodeARC SH-NT
2. Diameter D
3. Length L
4. Extension Diameter..... ED
5. Extension Length EL
6. Material

ARC STUDS SHOULDER-THREADED

ARC SH-T

STUD						
D	MIN L	TD	MAX TL	FD	FH	FERRULE CODE
1/4	.312	#8	.437	.359	.109	F250
5/16	.375	#10	.500	.437	.109	F312
3/8	.375	1/4	.750	.500	.125	F375
7/16	.437	5/16	.875	.578	.140	F437
1/2	.500	3/8	1.000	.627	.156	F500
5/8	.625	1/2	1.250	.796	.187	F625
3/4	.625	5/8	1.625	.937	.250	F750
7/8	.750	3/4	1.875	1.093	.312	F875

THREADS: Standard thread is UNC-2A (Rolled when possible), other threads are available upon request.

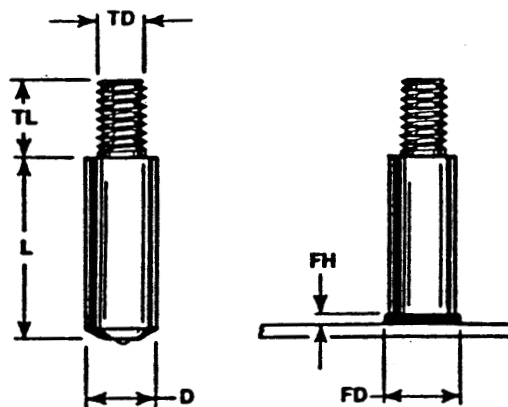

MATERIAL	LOW CARBON STEEL C - 0.23% max. Mn - 0.90% max.	P - 0.04% max. S - 0.05% max.	STAINLESS STEEL AISI grade - 302/304/305 std. Other grades available upon request.
MECHANICAL PROPERTIES	Tensile 60,000 psi (min.) Yield 50,000 psi (min.) Elongation 20% (in 2 inches)		Values for various grades available upon request.
PLATING	Plating is not standard. Copper, Nickel, and Zinc available upon customer request.		Does not apply to Stainless.

FERRULES: Ferrules are component parts of studs.
Not sold separately.

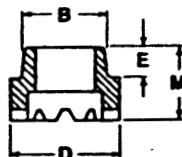

- TO ORDER OR SPECIFY GIVE:**
1. Product Code ARC SH-T
 2. Diameter D
 3. Length L
 4. Thread Diameter TD
 5. Thread Length TL
 6. Material

ARC STUDS
RECTANGULAR—with HOLE

ARC R-WH

STUD				
W	MIN L	D	X	FERRULE CODE
3/8	7/8	.203	5/16	R375
5/8	1"	.312	5/16	R625

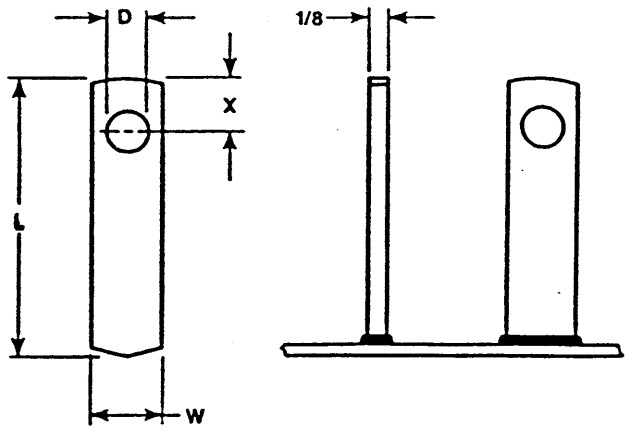

MATERIAL	LOW CARBON STEEL C - 0.23% max. P - 0.04% max. Mn - 0.90% max. S - 0.05% max.	STAINLESS STEEL AISI grade - 18-8 Other grades available upon request.
MECHANICAL PROPERTIES	Tensile 60,000 psi (min.) Yield 50,000 psi (min.) Elongation 20% (in 2 inches)	Values for various grades available upon request.
PLATING	Plating is not standard. Copper, Nickel, and Zinc available upon customer request.	Does not apply to Stainless.

FERRULES: Ferrules are component parts of studs.
Not sold separately.

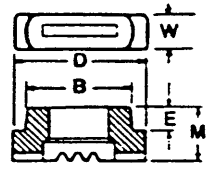

- TO ORDER OR SPECIFY GIVE:**
1. Product Code ARC R-WH
 2. Size 1/8 x W
 3. Length L
 4. Material

ARC STUDS RECTANGULAR - 'T' SLOTTED

ARC R-TS

STUD					
W	MIN L	OH	SH	X	SW
3/8	1/2	.322	.531	.765	.130
5/8	1/2	.500	1.000	1.250	.255

STUD (continued)				
B	FW	FL	FH	FERRULE CODE
.122	.218	.437	.125	R375
.185	.218	.687	.156	R625

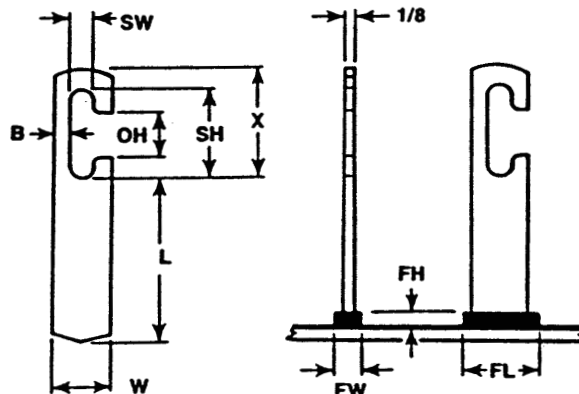

MATERIAL	LOW CARBON STEEL C - 0.23% max. P - 0.04% max. Mn - 0.90% max. S - 0.05% max.	STAINLESS STEEL AISI grade - 18-8 Other grades available upon request.
MECHANICAL PROPERTIES	Tensile 60,000 psi (min.) Yield 50,000 psi (min.) Elongation 20% (in 2 inches)	Values for various grades available upon request.
PLATING	Plating is not standard. Copper, Nickel, and Zinc available upon customer request.	Does not apply to Stainless.

FERRULES: Ferrules are component parts of studs.
Not sold separately.

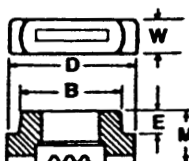

TO ORDER OR SPECIFY GIVE:

1. Product Code ARC R-TS
2. Size 1/8 x W
3. Length L
4. Material

ARC STUDS
NOTCHED END (NAVY)

ARC NE

STUD		
D	MIN L	FERRULE CODE
3/16	3/4"	F187

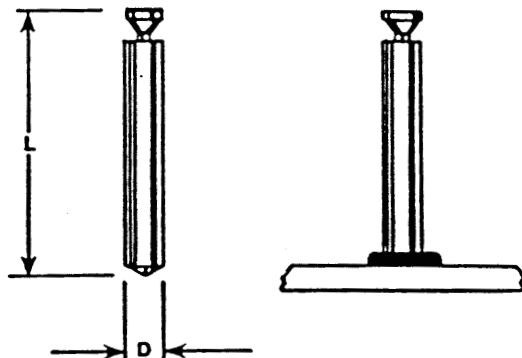

MATERIAL	LOW CARBON STEEL	STAINLESS STEEL
	C - 0.23% max. Mn - 0.90% max.	P - 0.04% max. S - 0.05% max. Other grades available upon request.
MECHANICAL PROPERTIES	Tensile 60,000 psi (min.) Yield 50,000 psi (min.) Elongation 20% (in 2 inches)	Values for various grades available upon request.
PLATING	Plating is not standard. Copper, Nickel, and Zinc available upon customer request.	Does not apply to Stainless.

WCN NE KHS

Key Hole Slotted Washer

Galvanized
Plated.

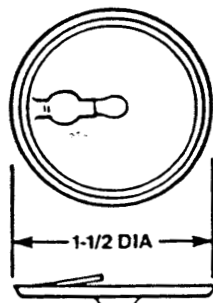

WASHER: Sold separately. Not a component part of stud.

FERRULES: Ferrules are component parts of studs. Not sold separately.

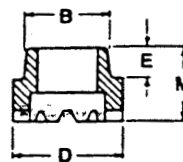

TO ORDER OR SPECIFY GIVE:

1. Product Code ARC NE
2. Size D
3. Length L
4. Material

ARC STUDS
RECTANGULAR—PLAIN

ARC R-PL

STUD					
W	MIN L	FW	FL	FH	FERRULE CODE
3/8	7/8	.218	.437	.125	R375
5/8	1"	.218	.687	.156	R625

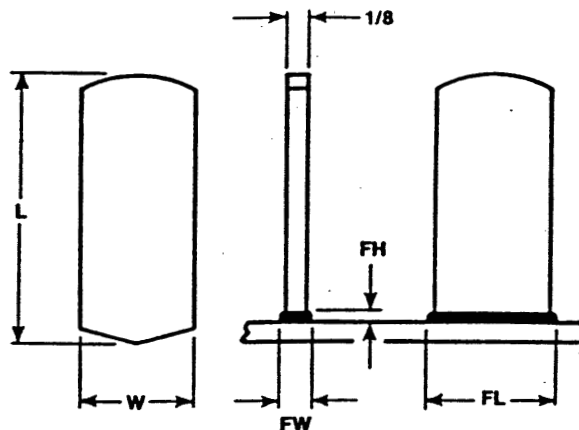

MATERIAL	LOW CARBON STEEL C - 0.23% max. P - 0.04% max. Mn - 0.90% max. S - 0.05% max.	STAINLESS STEEL AISI grade - 18-8 Other grades available upon request.
MECHANICAL PROPERTIES	Tensile 60,000 psi (min.) Yield 50,000 psi (min.) Elongation 20% (in 2 inches)	Values for various grades available upon request.
PLATING	Plating is not standard. Copper, Nickel, and Zinc available upon customer request.	Does not apply to Stainless.

FERRULES: Ferrules are component parts of studs.
Not sold separately.

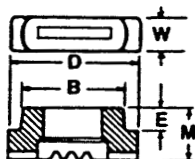

TO ORDER OR SPECIFY GIVE:

1. Product Code **ARC R-PL**
2. Size **1/8 x W**
3. Length **L**
4. Material

ARC STUDS
 "J" BOLT

ARC JB

STUD				
D	MIN L	MIN ID	MIN E	FERRULE CODE
3/16	1-1/8	1/2	1	F187
1/4	1-1/4	5/8	1-1/8	F250
5/16	1-1/2	3/4	1-1/4	F312
3/8	1-5/8	7/8	1-3/8	F375
7/16	1-3/4	1	1-1/2	F437
1/2	2	1	1-1/2	F500
5/8	2-1/2	1-1/2	1-7/8	F625

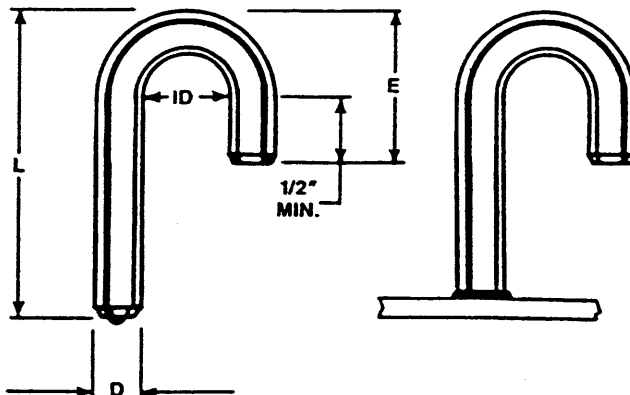

MATERIAL	LOW CARBON STEEL	STAINLESS STEEL
	C - 0.23% max. P - 0.04% max. Mn - 0.90% max. S - 0.05% max.	AISI grade - 302/304/305 std. Other grades available upon request.
MECHANICAL PROPERTIES	Tensile 60,000 psi (min.) Yield 50,000 psi (min.) Elongation 20% (in 2 inches)	Values for various grades available upon request.
PLATING	Plating is not standard. Copper, Nickel, and Zinc available upon customer request.	Does not apply to Stainless.

FERRULES: Ferrules are component parts of studs.
 Not sold separately.

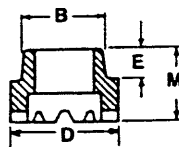

TO ORDER OR SPECIFY GIVE:

1. Product Code **ARC JB**
2. Size **D**
3. Length **L**
4. "J" Diameter **ID**
5. Extension **E**
6. Material

RP Rectangular Welding Pins

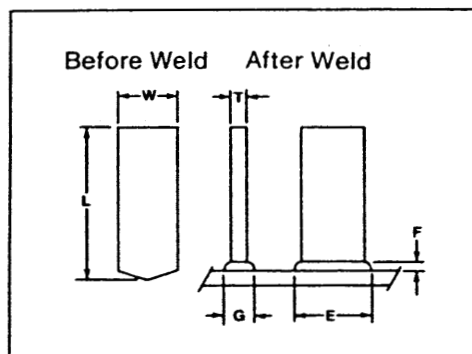

RP (Rectangular Pins) 1/4" x 1-1/4" are flat stud welding fasteners.

Typical Use: Combustion chamber baffles on tube walls of power boilers.

Length Specifications: Available in any length from specified minimum.

Materials: Low carbon or stainless steel.

Arc Shields: All orders include arc shields, which are supplied with the studs and are not sold individually.

To Order: Specify RP studs, quantity, T, W, L(BW), material, arc shield.

Specifications

T	W	Minimum Length		E	Approximate Weld Bead Dimensions		Arc Shield Number
		Before Weld L(BW)	After Weld (Nom.) L(AW)		F	G	
1/4	1-1/4	1-1/2	1-3/8	1-5/16	3/16	15/32	009-628

RPP Rectangular Pierced Welding Pins

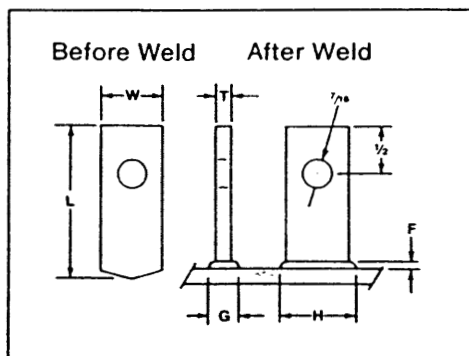

RPP (Rectangular Pierced Pins) are flat stud welding fasteners pierced with a 7/16" hole, with its center line 1/2" from the top of the fastener.

Typical Use: Attachment of electrical wireways on ships.

Length Specifications: Available in any length from specified minimum.

Materials: Low carbon or stainless steel.

Arc Shields: All orders include arc shields which are supplied with the study and are not sold individually.

To Order: Specify RPP studs, quantity, T, W, L(BW), material, arc shield.

Specifications

T	W	Minimum Length		E	Approximate Weld Bead Dimensions		Arc Shield Number
		Before Weld L(BW)	After Weld (Nom.) L(AW)		F	G	
1/4	1-1/4	1-1/2	1-3/8	1-5/16	3/16	15/32	009-628