

# Galvanized Pins & Plastic Washers

## Features:

- Fasteners for Flange Protectors
- Available in 4 lengths

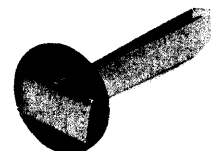

## PINS

#1 – 2 ¼” Long Pins

#2 – 3 ¼” Long Pins

#6 – 6” Long Pins

#8 – 8” Long Pins

## Plastic Washers

#1 1-3/8” O.D. with slot bolt holes up to 1-1/8” diameter

#2 1-3/4” O.D. with slot bolt holes up to 1-1/2” diameter

#3 2-1/2” O.D. with slot bolt holes up to 2-1/4” diameter

#3 2-1/2” O.D. with slot bolt holes up to 2-1/4” diameter

## BOLT HOLE PLUGS FOR FAN SERIES *FBH Series*



These plugs were designed to secure our FAN Series onto a flange. They have outer ribs to compensate for varying hole diameter tolerances, ensuring a secure fit. The FBH Series has a thick flange allowing for easy removal.



**Material:** High-Density Polyethylene **Color\*:** Black

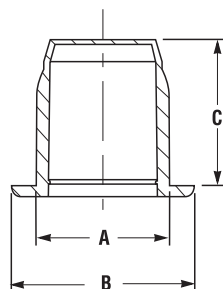

Caplug No.	Bolt Hole Size	Dimensions						Packaging		Used With
		A		B		C (Nominal)		Carton Quantity	Mini Pak Quantity	
		In	mm	In	mm	In	mm			
FBH-625	5/8	.635	16.13	1.03	26.16	.44	11.18	800	160	FAN-150-1/2, 150-3/4, 150-1, 150-1-1/4, 150-1-1/2, 300-1/2, 600-1/2
FBH-750	3/4	.761	19.33	1.12	28.45	.75	19.05	800	160	FAN-150-2, 150-2-1/2, 150-3, 150-3-1/2, 300-3/4, 300-1, 300-1-1/4, 300-2, 600-3/4, 600-1, 600-1-1/4, 600-2
FBH-875	7/8	.888	22.56	1.28	32.51	.94	23.88	800	160	FAN-150-4, 150-5, 150-6, 150-8, 300-1-1/2, 300-2-1/2, 300-3, 300-3-1/2, 300-4, 300-5, 300-6, 600-1-1/2, 600-3, 900-1/2, 900-3/4
FBH-1000	1	1.020	25.91	1.43	36.32	1.19	30.23	800	160	FAN-150-10, 150-12, 300-8, 600-3-1/2, 600-4, 900-1, 900-1-1/4, 900-2, 900-3
FBH-1125	1-1/8	1.142	29.01	1.56	39.62	1.25	31.75	600	120	FAN-150-14, 150-16, 300-10, 600-5, 600-6, 900-1-1/2, 900-2-1/2
FBH-1250	1-1/4	1.269	32.23	1.68	42.67	1.25	31.75	600	120	FAN-150-18, 150-20, 300-12, 300-14, 600-8, 900-4, 900-6
FBH-1375	1-3/8	1.396	35.46	1.78	45.21	1.25	31.75	600	120	FAN-300-16, 300-18, 600-10, 600-12, 900-5
FBH-1500	1-1/2	1.530	38.86	1.93	49.02	1.25	31.75	400	80	FAN-600-14, 900-8, 900-10, 900-12
FBH-1625	1-5/8	1.650	41.91	2.03	51.56	1.25	31.75	400	80	FAN-600-16, 900-14
FBH-1750	1 7/9	1.775	45.07	2.18	55.35	1.25	31.74	500	100	FAN-300-26A, 300-28A, 300-38B, 300-40A, 300-40B, 300-42A, 400-22, 400-32B, 400-34B, 600-22, 600-26B
FBH-1875	1 8/9	1.902	48.29	2.31	58.65	1.25	31.74	400	80	FAN-300-42B, 300-44A, 300-44B, 400-24, 400-26A, 400-36B, 400-38A, 400-38B, 600-28B, 2500-5
FBH-2000	2	2.040	51.80	2.43	61.70	1.25	31.74	400	80	FAN-300-32A, 300-34A, 300-46A, 300-46B, 300-48A, 300-48B, 400-28A, 400-40A, 400-40B, 400-42A, 400-42B, 600-24, 600-26A, 600-30B, 900-18
FBH-2125	2 1/6	2.156	54.74	2.56	65.00	1.62	41.13	300	60	FAN-400-30A, 400-32A, 400-34A, 400-36A, 400-44A, 400-44B, 400-46A, 400-46B, 600-28A, 600-30A, 600-32B, 2500-6, 2500-8
FBH-2375	2 2/5	2.410	61.19	2.81	71.35	1.62	41.13	300	60	FAN-400-48A, 400-48B, 600-32A, 600-34A, 600-34B, 600-36B, 600-38A, 600-38B, 600-40A, 600-40B, 1500-14
FBH-2625	2 2/3	2.664	67.64	3.09	78.46	1.62	41.13	200	40	FAN-600-36A, 600-42A, 600-42B, 600-44A, 600-44B, 600-46A, 600-46B, 900-24, 900-26B, 1500-16, 2500-10
FBH-2875	2 8/9	2.918	74.09	3.31	84.04	1.62	41.13	200	40	FAN-900-26A, 900-28A, 1500-18, 2500-12

# CAB Series Cable Ties



Cable ties are an inexpensive solution to your bundling needs. Made of durable 6/6 nylon, we offer a wide variety of lengths and tensile strengths for a wide variety of applications. Our line of cable ties ranges from 4.1" and 18 lb. up to 48" and 175 lb. in both natural and UV black.



Material: Nylon Color: Natural, UV Black

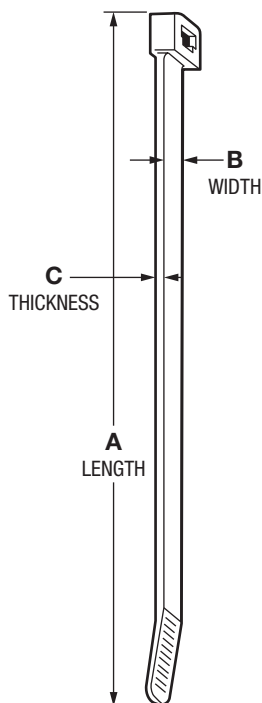

Caplug No.	Color	Dimensions										Packaging Quantity / Bag
		A		B		C		Tensile Strength		Max Bundle Diameter		
		In	mm	In	mm	In	mm	lbs.	kg	In	mm	
CAB-B4M9M	Natural	4.10	104.10	.10	2.54	.04	1.02	18	39.71	.62	15.74	1000
CAB-B4M0M	UV Black	4.10	104.10	.10	2.54	.04	1.02	18	39.71	.62	15.74	1000
CAB-B6M9M	Natural	6.10	154.88	.10	2.54	.04	1.02	18	39.71	1.25	31.74	1000
CAB-B6M0M	UV Black	6.10	154.88	.10	2.54	.04	1.02	18	39.71	1.25	31.74	1000
CAB-B8M9M	Natural	8.10	205.66	.10	2.54	.04	1.02	18	39.71	2.00	50.78	1000
CAB-B8M0M	UV Black	8.10	205.66	.10	2.54	.04	1.02	18	39.71	2.00	50.78	1000
CAB-B519M	Natural	5.70	144.72	.14	3.55	.05	1.27	40	88.24	1.25	31.74	1000
CAB-B510M	UV Black	5.70	144.72	.14	3.55	.05	1.27	40	88.24	1.25	31.74	1000
CAB-B819M	Natural	8.20	208.20	.14	3.55	.05	1.27	40	88.24	2.00	50.78	1000
CAB-B810M	UV Black	8.20	208.20	.14	3.55	.05	1.27	40	88.24	2.00	50.78	1000
CAB-B7S9M	Natural	8.00	203.12	.19	4.82	.05	1.27	50	110.30	2.00	50.78	1000
CAB-B7S0M	UV Black	8.00	203.12	.19	4.82	.05	1.27	50	110.30	2.00	50.78	1000
CAB-B11S9M	Natural	11.80	299.60	.19	4.82	.05	1.27	50	110.30	3.00	76.17	1000
CAB-B11S0M	UV Black	11.80	299.60	.19	4.82	.05	1.27	50	110.30	3.00	76.17	1000
CAB-B14S9M	Natural	14.80	375.77	.19	4.82	.05	1.27	50	110.30	4.00	101.56	1000
CAB-B14S0M	UV Black	14.80	375.77	.19	4.82	.05	1.27	50	110.30	4.00	101.56	1000
CAB-B17S9C	Natural	17.00	431.63	.19	4.82	.05	1.27	50	110.30	5.00	126.95	100
CAB-B17S0C	UV Black	17.00	431.63	.19	4.82	.05	1.27	50	110.30	5.00	126.95	100
CAB-B8L9C	Natural	9.00	228.51	.30	7.62	.08	2.03	120	264.72	2.00	50.78	100
CAB-B8L0C	UV Black	9.00	228.51	.30	7.62	.08	2.03	120	264.72	2.00	50.78	100
CAB-B11L9C	Natural	12.10	307.22	.30	7.62	.08	2.03	120	264.72	3.00	76.17	100
CAB-B11L0C	UV Black	12.10	307.22	.30	7.62	.08	2.03	120	264.72	3.00	76.17	100
CAB-B14L9C	Natural	15.00	380.85	.30	7.62	.08	2.03	120	264.72	4.00	101.56	100
CAB-B14L0C	UV Black	15.00	380.85	.30	7.62	.08	2.03	120	264.72	4.00	101.56	100
CAB-B24H9L	Natural	25.20	639.83	.35	8.89	.08	2.03	175	386.05	7.00	177.73	50
CAB-B24H0L	UV Black	25.20	639.83	.35	8.89	.08	2.03	175	386.05	7.00	177.73	50
CAB-B36H9L	Natural	36.50	926.74	.35	8.89	.08	2.03	175	386.05	10.70	271.67	50
CAB-B36H0L	UV Black	36.50	926.74	.35	8.89	.08	2.03	175	386.05	10.70	271.67	50
CAB-B48H9L	Natural	48.00	1218.72	.35	8.89	.08	2.03	175	386.05	15.00	380.85	50
CAB-B48H0L	UV Black	48.00	1218.72	.35	8.89	.08	2.03	175	386.05	15.00	380.85	50



**CAB-200TT** Tensioning tool for use with 18 lb. through 50 lb. cable ties

**CAB-300TT** Tensioning tool for use with 120 lb. through 175 lb. cable ties